

Construction Examples - 44 mm Door

30' Fire Door

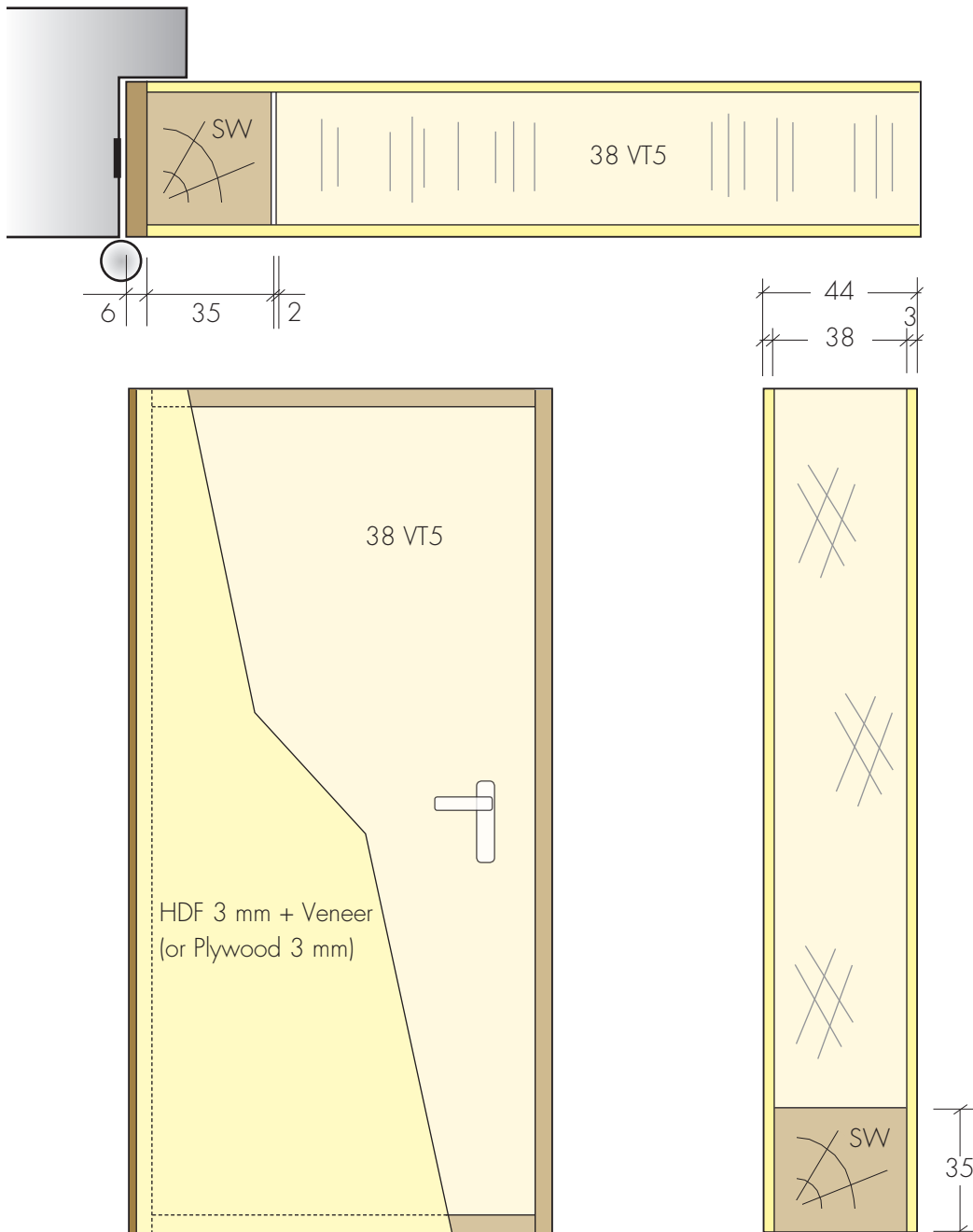

Construction :

- Core: 38 VT5
- Stile/ rails: softwood 'SW'
- Door skin: HDF or plywood 3mm
- Lipping: hardwood 6 mm

Results :

- Weight: approx. 23,5 kg/m²
- Stability: heavy duty
- Fire: 40 min
- Sound: 32 dB